

P O T T E R Y B A R N

Clarissa Chandelier Large Round Assembly and Installation Instructions

CAUTION:

- **BEFORE INSTALLING FIXTURE, MAKE SURE THE POWER TO THE CIRCUIT IS TURNED OFF AT THE MAIN FUSE BOX / CIRCUIT BREAKER UTILITY BOX.**

Important Safety Instructions:

- These instructions are provided for your safety. It is very important that they are read carefully and completely before beginning the assembly and installation of this lighting fixture.
- **We strongly recommend that a professional electrician install this lighting fixture.**
- THIS PRODUCT MUST BE INSTALLED IN ACCORDANCE WITH THE APPLICABLE INSTALLATION CODES BY A PERSON FAMILIAR WITH THE CONSTRUCTION AND OPERATION OF THE PRODUCT AND THE HAZARDS INVOLVED.
- **The weight of this lighting fixture exceeds 50 pounds and must be installed using an outlet box approved for up to 100 pound lighting fixture load.**
- **THIS LUMINAIRE MUST BE MOUNTED OR SUPPORTED INDEPENDENTLY OF AN OUTLET BOX.**
- The lighting fixture is meant for indoor use. It must be connected only to 3-wire, single-phase electrical supply systems (provided with Ground wire or equivalent protection system).
- For your safety, it is strongly recommended that two people install the lighting fixture.
- This fixture has been rated for up to three (3) **60-Watt maximum TYPE A standard incandescent light bulbs** (not included) or three (3) **13-Watt compact fluorescent light bulbs** (not included). To avoid the risk of fire, do not exceed the recommended lamp wattage.
- The lighting fixture is meant for indoor use, DRY LOCATIONS ONLY.
- **Save these instructions.**

WARNING:

- **To reduce the risk of fire, electrical shock or personal injury, always turn off light fixture and allow it to cool prior to replacing light bulb.**
- **Do not touch bulb when fixture is turned on. Do not look directly at lit bulb.**
- **Keep flammable materials away from lit bulb.**
- **This lighting fixture contains lead, a chemical known to the State of California to cause cancer, birth defects and other reproductive harm. Wash hands after installing, handling, cleaning or otherwise touching this light fixture.**

Pre-assembly:

- Remove all parts and hardware from box along with any plastic protective packaging.
- Do not discard any contents until after assembly is complete to avoid accidentally discarding small parts or hardware.
- For your safety and convenience, assembly by two people is recommended.

TOOLS REQUIRED (not included):

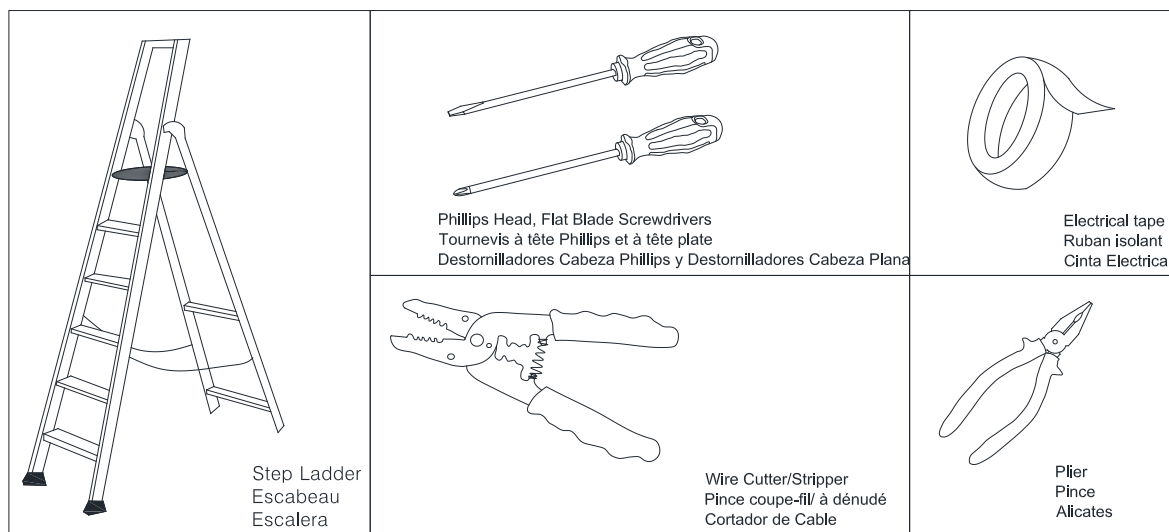

Parts Included:

- (I) Fixture Loop (1)
- (K) Light Fixture (1)
- (L) Large Glass Drops (277) (includes (10) extras)
- (M) Long Glass Drops (277) (includes (10) extras)
- (Q) Steel Cable (1)

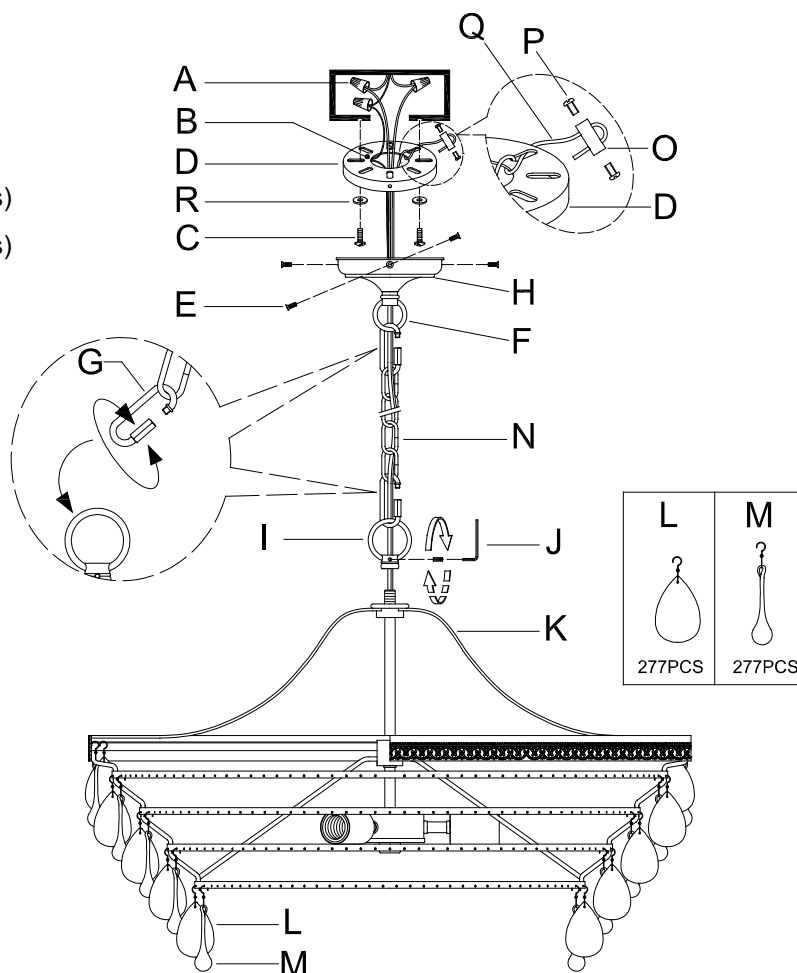

Hardware Enclosed:

- (A) Plastic Wire Nut Connectors (3)
- (B) Green Ground Screw (1)
- (C) Mounting Screws (3) (includes (1) extra)
- (D) Mounting Plate (1)
- (E) Canopy Screws (4)
- (F) Hanging Loop (1)
- (G) Closable Links with Screw Caps (2)
- (H) Canopy (1)
- (J) Allen Wrench (1)
- (N) Chain (1)
- (O) Binding Collar (1)
- (P) Set Screws (2)
- (R) Small Flat Washers (3) (includes (1) extra)

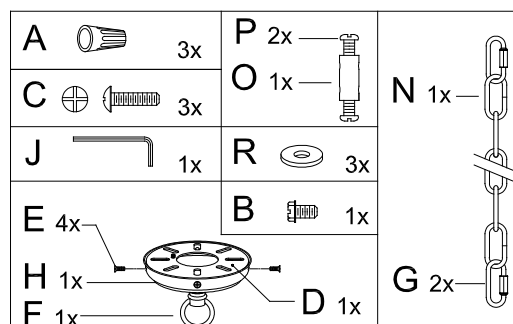

To adjust the suspension length of the fixture:

1. Note: The adjustment or shortening of the lighting fixture's suspension length is only needed if the factory set chain length is not appropriate for your installation. We recommend that you adjust the chain to the proper desired length before cutting the electrical cord. Determine the lighting fixture suspension length from the ceiling for the product installation, allowing the extra cord length for the outlet junction box wire connections as noted below.
2. (See A1) If needed, insert the fixture 2 wire power cord, bare ground wire and Steel Cable (Q) through the wiring holes of Fixture Loop (I). Attach the Fixture Loop (I) onto the threaded nipple at the top of the Light Fixture (K) by turning in a clockwise direction by hand until tight. Secure the Fixture Loop (I) in place by tightening the small inner screw in Fixture Loop (I) using Allen Wrench (J) until secure.

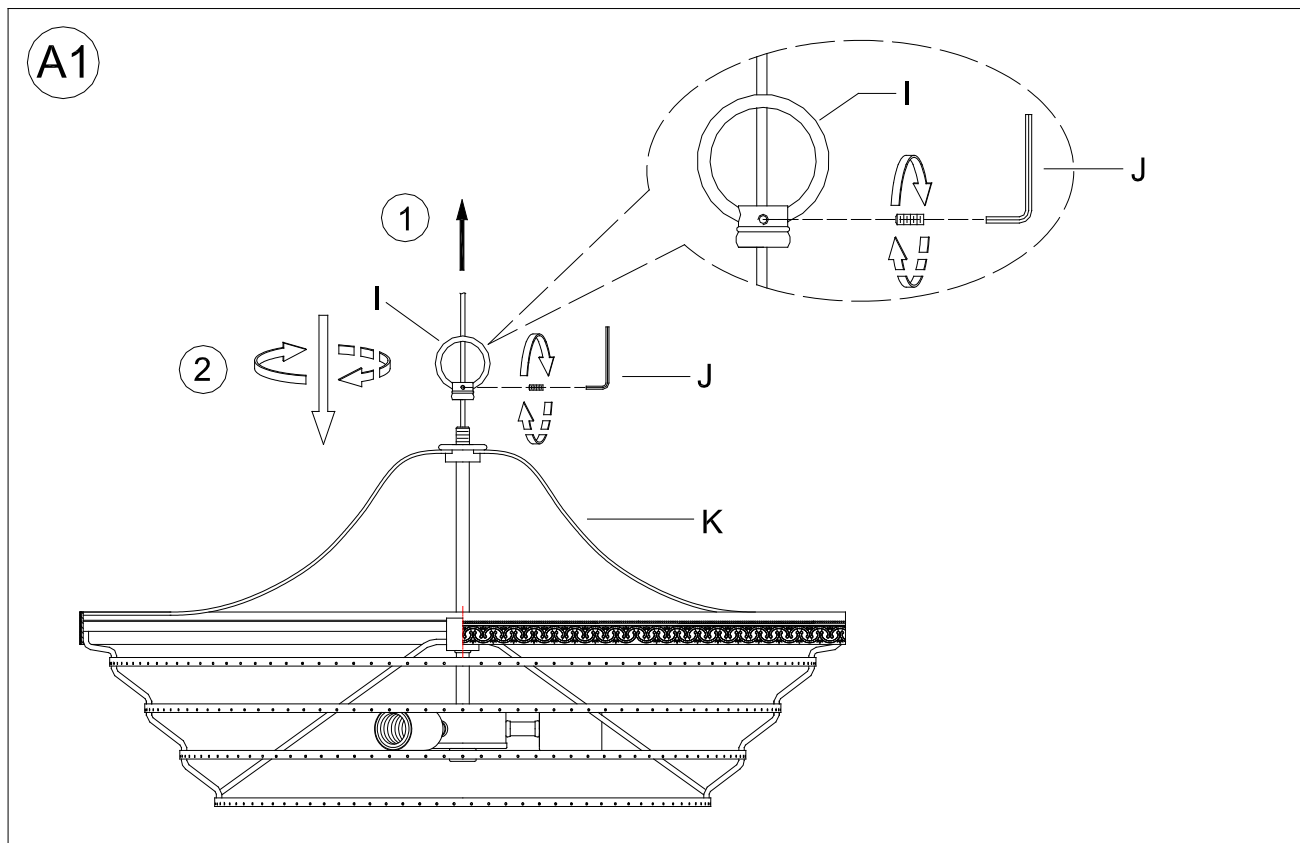

3. (See A2 & A3) The chain length may be shortened from either end. Use two pairs of pliers to gently pry the link apart along a split-line formed in each link so that a space is created large enough for the link to be removed from the remaining chain. Use a cloth or folded piece of paper between the pliers and the link to protect the finish of the link during bending. Once the Chain (N) is at the desired length, reattach the Chain (N) as shown in the diagram below. (See A4)

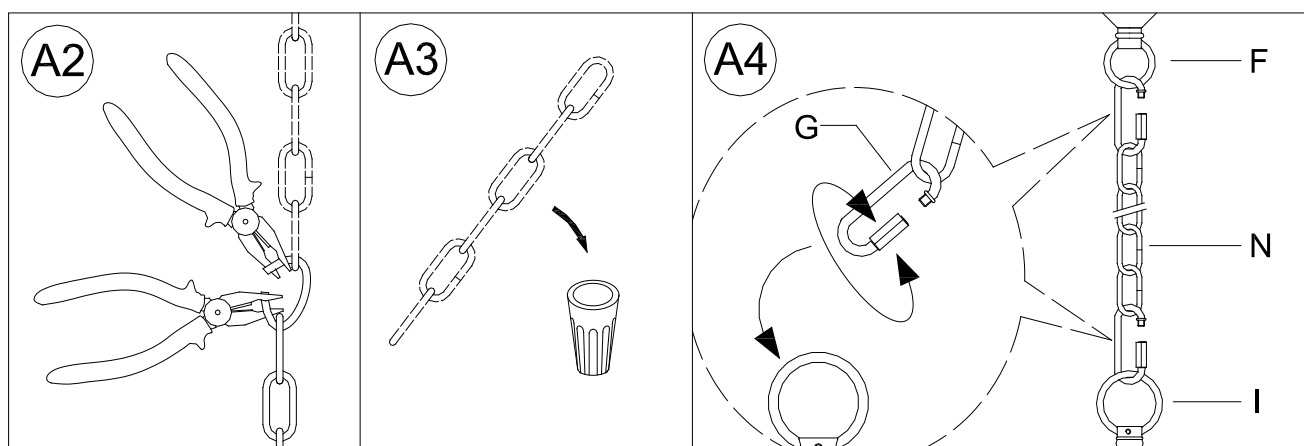

4. (See A5) Re-weave the fixture 2 wire power cord and bare ground wire, Steel Cable (Q) through every other loop to the top of Chain (N).

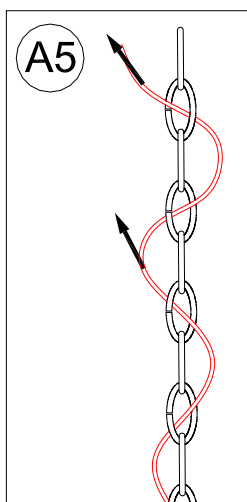

5. (See A6) If needed, cut off the extra power cord length on the 2 wire cord and bare ground wire so that they all are at least 6 inches (152.4 mm) long within the outlet junction box (J-box).

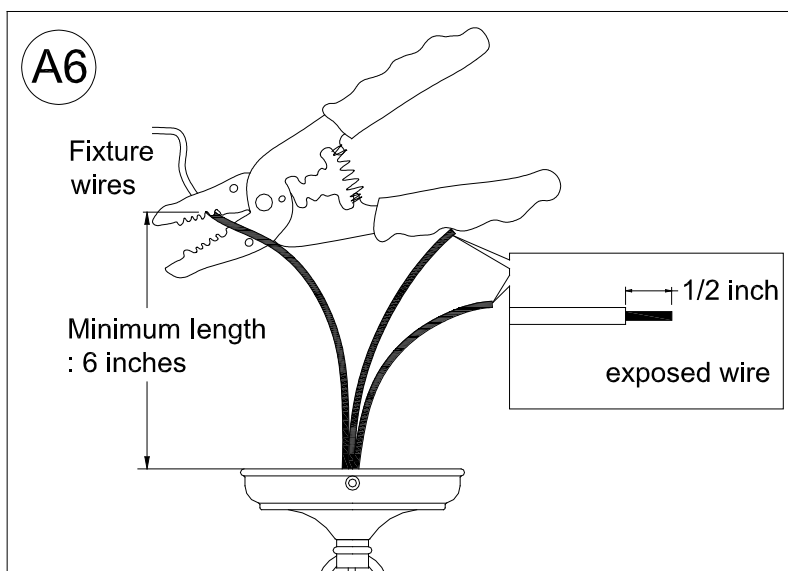

Assembly & Installation Instructions:

- **SHUT OFF THE MAIN ELECTRICAL SUPPLY FROM THE MAIN FUSE BOX/CIRCUIT BREAKER.**
- Carefully unpack all fixture parts and hardware and lay them on a clear workspace.

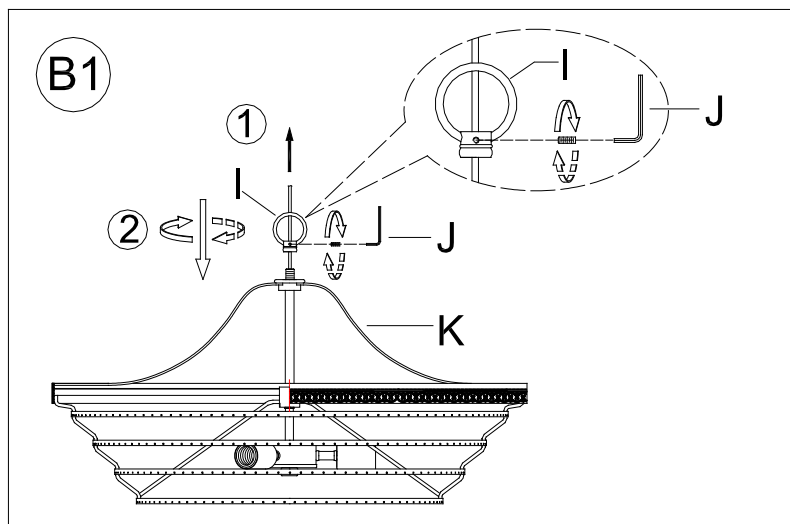

If the parts had not been assembled:

1. Insert the fixture 2 wire power cord, bare ground wire and Steel Cable (Q) through the wiring holes of Fixture Loop (I).
2. Attach the Fixture Loop (I) onto the threaded nipple at the top of the Light Fixture (K) by turning in a clockwise direction by hand until tight. Secure the Fixture Loop (I) in place by tightening the small inner screw in Fixture Loop (I) using Allen Wrench (J) until secure.

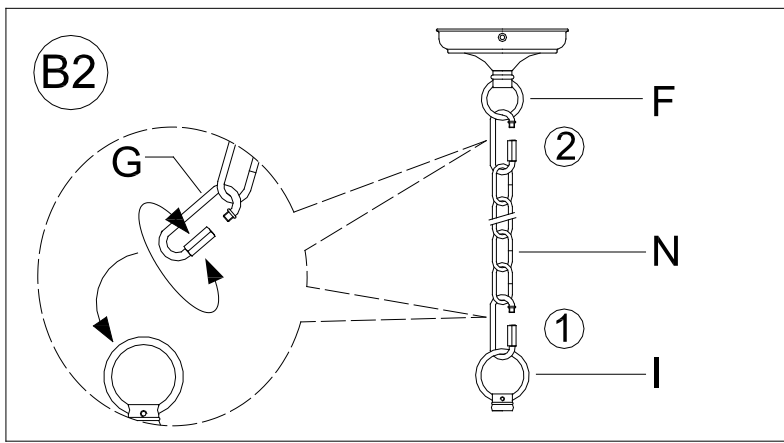

1. Insert the bottom loop of Chain (N) and Fixture Loop (I) into the Closable Link (G), tighten the Closable Link Screw Cap.
2. Insert the top loop of Chain (N) and Hanging Loop (F) into the Closable Link (G), tighten the Closable Link Screw Cap.

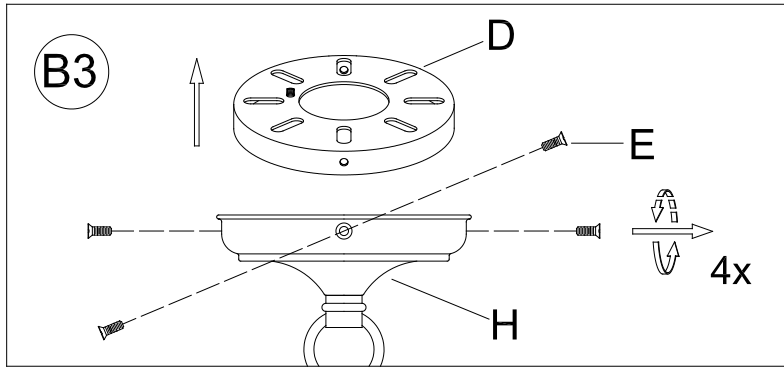

Separate the Mounting Plate (D) from the Canopy (H) by removing 4 Canopy Screws (E). Do not discard the Canopy Screws (E) as these will be used later.

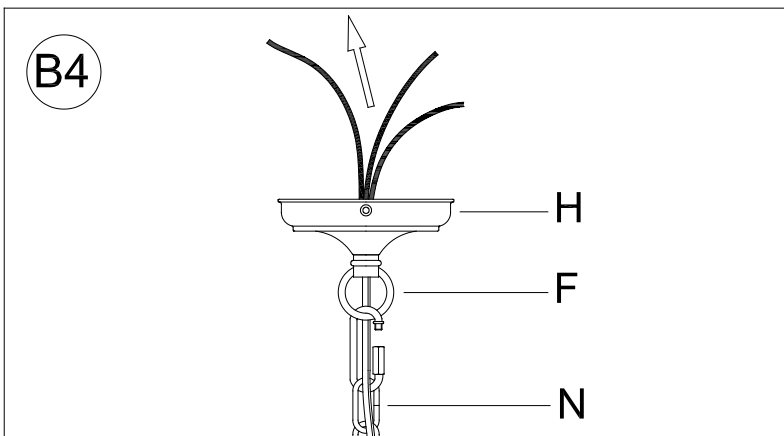

Weave the fixtures 2 wire power cord and bare ground wire, Steel Cable (Q) through every other loop to the top of Chain (N) and then through wiring hole of the Hanging Loop (F) on the Canopy (H).

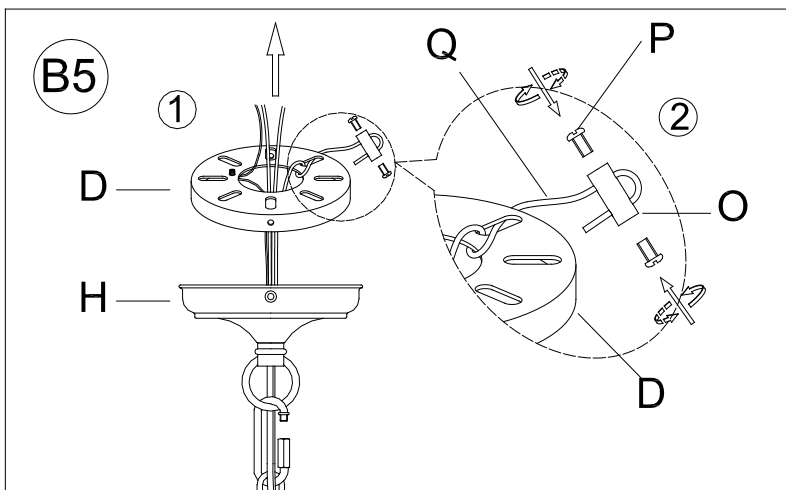

1. Unscrew the 2 Set Screws (P) from the Binding Collar (O) using a screwdriver.
 2. Wrap the top end of Steel Cable (Q) onto the slots of the Mounting Plate (D), and then wrap the end of Steel Cable (Q) through the holes of Binding Collar (O), insert the two Set Screws (P) and tighten using a screwdriver.
- **Ensure the Steel Cable (Q) tightly looped between Binding Collar (O) holes and is properly secured by the Set Screws (P) or safety will be compromised.**
 - **Adjust the Steel Cable (Q) length so only the Steel Cable (Q) (without fixture power cord) support the weight of lighting fixture after wire connection in step B7 is completed.**

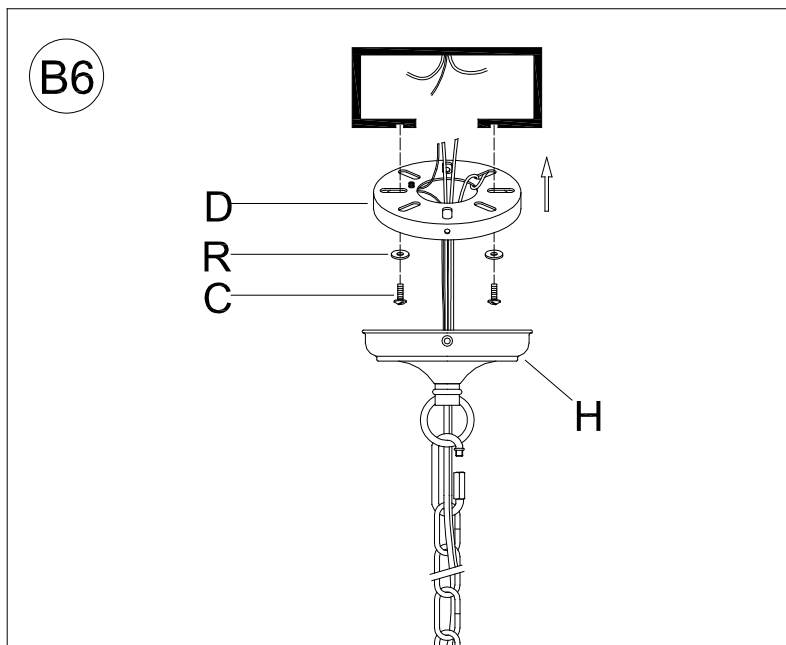

With the help of another person to hold the weight of light fixture, attach the Mounting Plate (D) to the ceiling outlet box using the 2 Small Flat Washers (R) and the 2 J-box Mounting Screws (C). Tighten each screw to secure the Mounting Plate (D) in place.

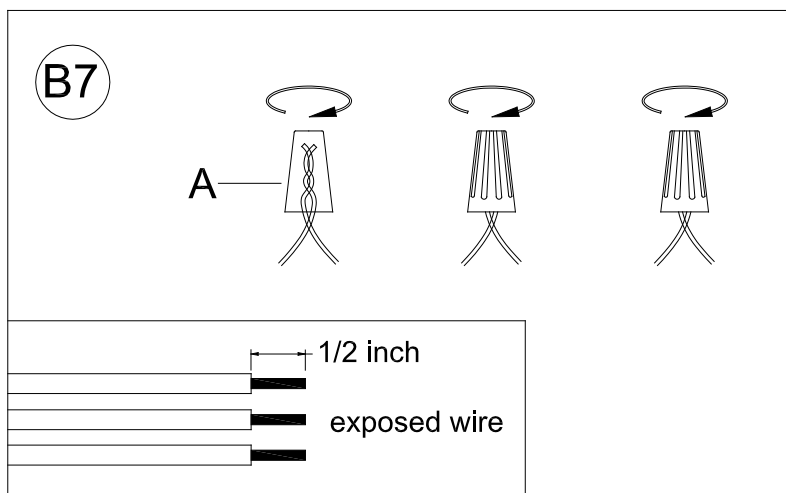

Please read the section **“To Make the Wire Connections”** Below.

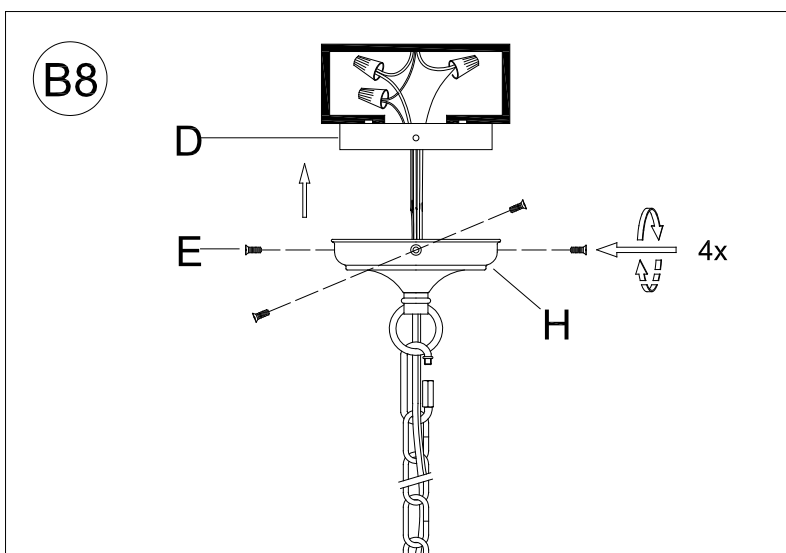

With the help of another person to hold the weight of light fixture, raise the Canopy (H) over the Mounting Plate (D), aligning the 4 holes on the Canopy (H) with the 4 threaded holes on the Mounting Plate (D). Insert the Canopy Screw (E) and tighten to secure the Canopy (H).

B9

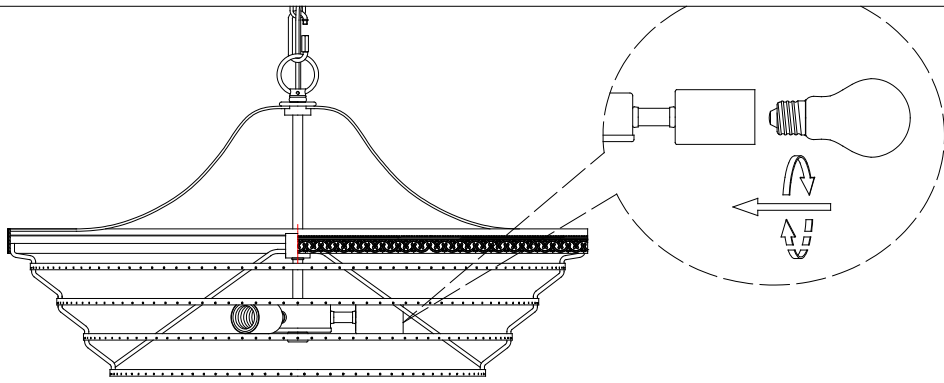

Insert the specified light bulbs into the sockets. **DO NOT EXCEED THE SPECIFIED WATTAGE.**

B10

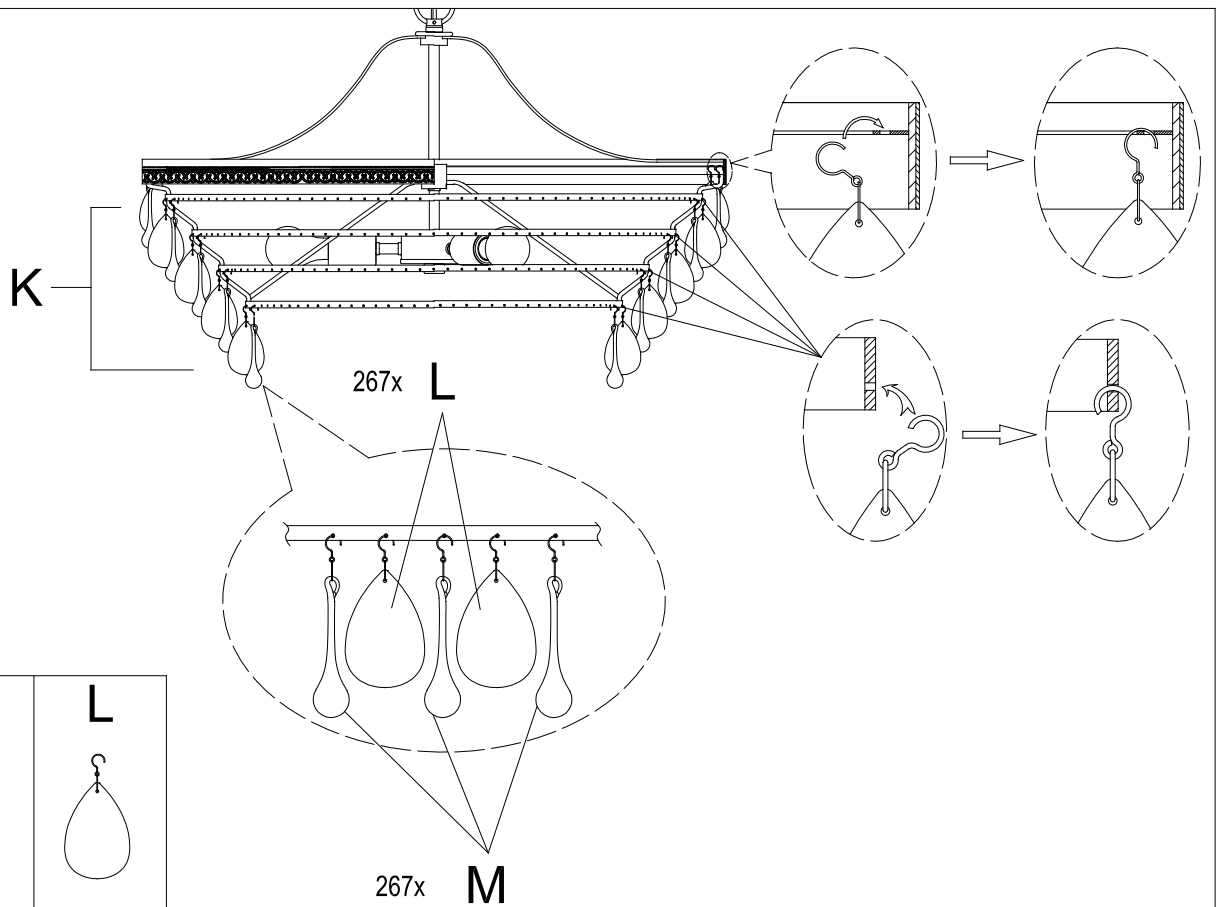

Attach the Large Glass Drops (L) and Long Glass Drops (M) onto each loop of Light Fixture (K) .Use every other hole for the Long Glass Drops (M) loop placement first and then attach the Large Glass Drops (L) to the remaining holes on the loop of Light Fixture (K).

(Glass drop installation sequence is recommended from bottom to top)

To Make the Wire Connections:

1. Gently pull existing wire down from the ceiling junction box and allow wires to hang. The HOT or LIVE wire is usually black. The NEUTRAL wire is usually white. Check to see if there is a ground wire that is usually green or green with a yellow stripe or exposed copper metal wire. If needed, use a pair of wire strippers to remove about 1/2 inch of insulation from each wire.
2. Carefully inspect the fixture wires. The NEUTRAL FIXTURE WIRE has FINE LONGITUDINAL RIDGES running along its length. The HOT FIXTURE WIRE is SMOOTH and the BARE COPPER WIRE is the GROUND WIRE. If you have any doubt and cannot identify the power-supply wires with confidence, then we recommend that you ask an electrician and that you not continue with the installation.
3. With the help of another person to hold the weight of the fixture, attach the fixture wires to the junction box wires as shown in the illustrations.

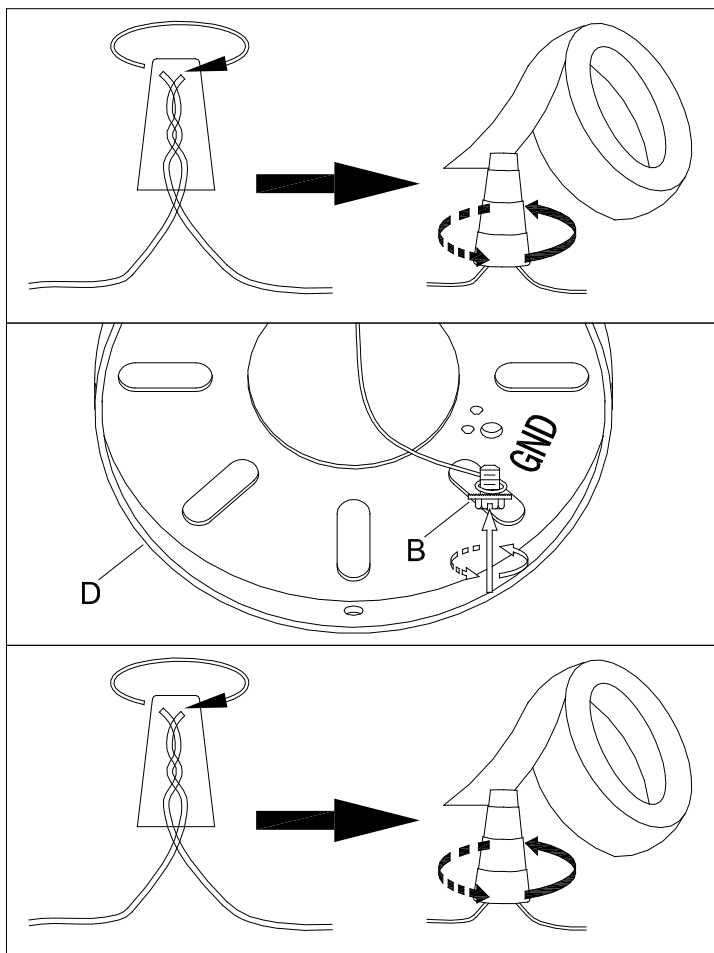

Connect the GROUND FIXTURE WIRE to the GROUND J-BOX WIRE (usually green insulation of bare wire) using the Plastic Wire Nut Connector (A) and wrap the connection with electrical tape. Be sure that no wire strands are exposed.

If the junction box DOES NOT have a GROUND WIRE, wrap the fixture's bare ground wire around the Green Ground Screw (B) and insert the screw into the Mounting Plate (D), marked as "GND", and tighten screw to secure the wire.

Connect the NEUTRAL FIXTURE WIRE to the NEUTRAL J-BOX WIRE (usually white insulation) first and then connect the HOT FIXTURE WIRE to the HOT J-BOX WIRE (usually black insulation) using the Plastic Wire Nut Connectors (A). Wrap these connections with electrical tape. Be sure that no wire strands are exposed.

NOTE:

IT IS IMPERATIVE THAT THE JUNCTION BOX IN YOUR HOME BE PROPERLY GROUNDED!

DO NOT REVERSE THE HOT AND NEUTRAL CONNECTIONS OR SAFETY WILL BE COMPROMISED.

4. Check the wiring connections and if all looks good, gently tuck the wire connections neatly into the ceiling junction box.

Care instructions:

- Wipe clean with a soft, dry cloth or static duster.
- Always avoid the use of harsh chemicals or abrasive cleaners as they may cause damage to the fixture's finish.

Thank you for your purchase

Stores / Catalog / www.potterybarn.com

USA 1.888.779.5176